



Provincia Autonoma di Trento

COMUNE DI ALTOPIANO DELLA VIGOLANA

APRILE 2022

TAVOLA

3C

OSSERVAZIONI

Scala
1 : 500

PIANO REGOLATORE GENERALE
INSEDIAMENTI STORICI
INDIVIDUAZIONE AREE OSSERVAZIONI

CENTA SAN NICOLÒ MATRICE 31 A 38



architetto fulvio bertoluzzi
Via S. Pietro, 10 - 38122 Trento
studiobertoluzzi@gmail.com

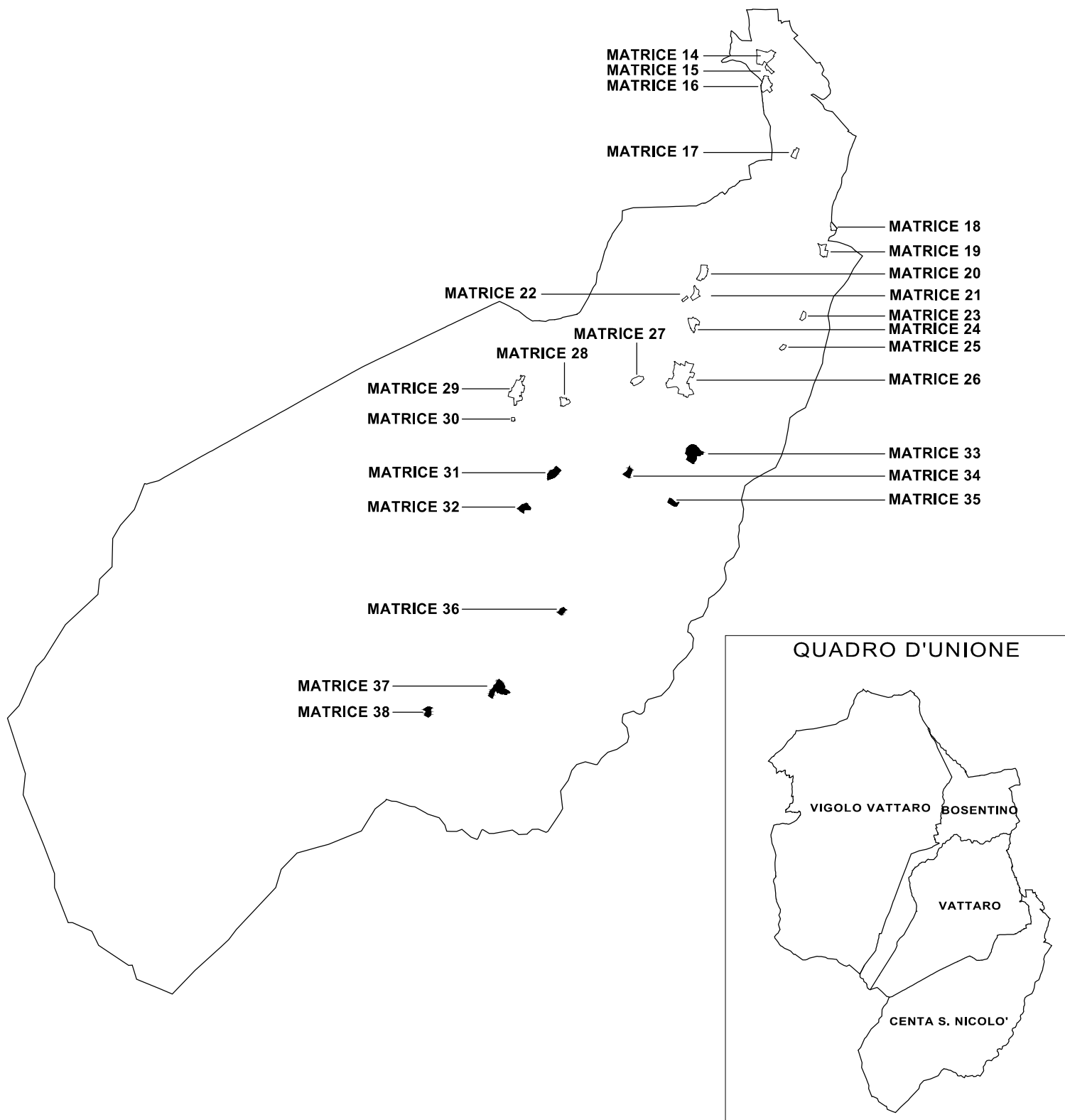

LEGENDA RETINI



AREE OGGETTO DI OSSERVAZIONI

MATRICE 31

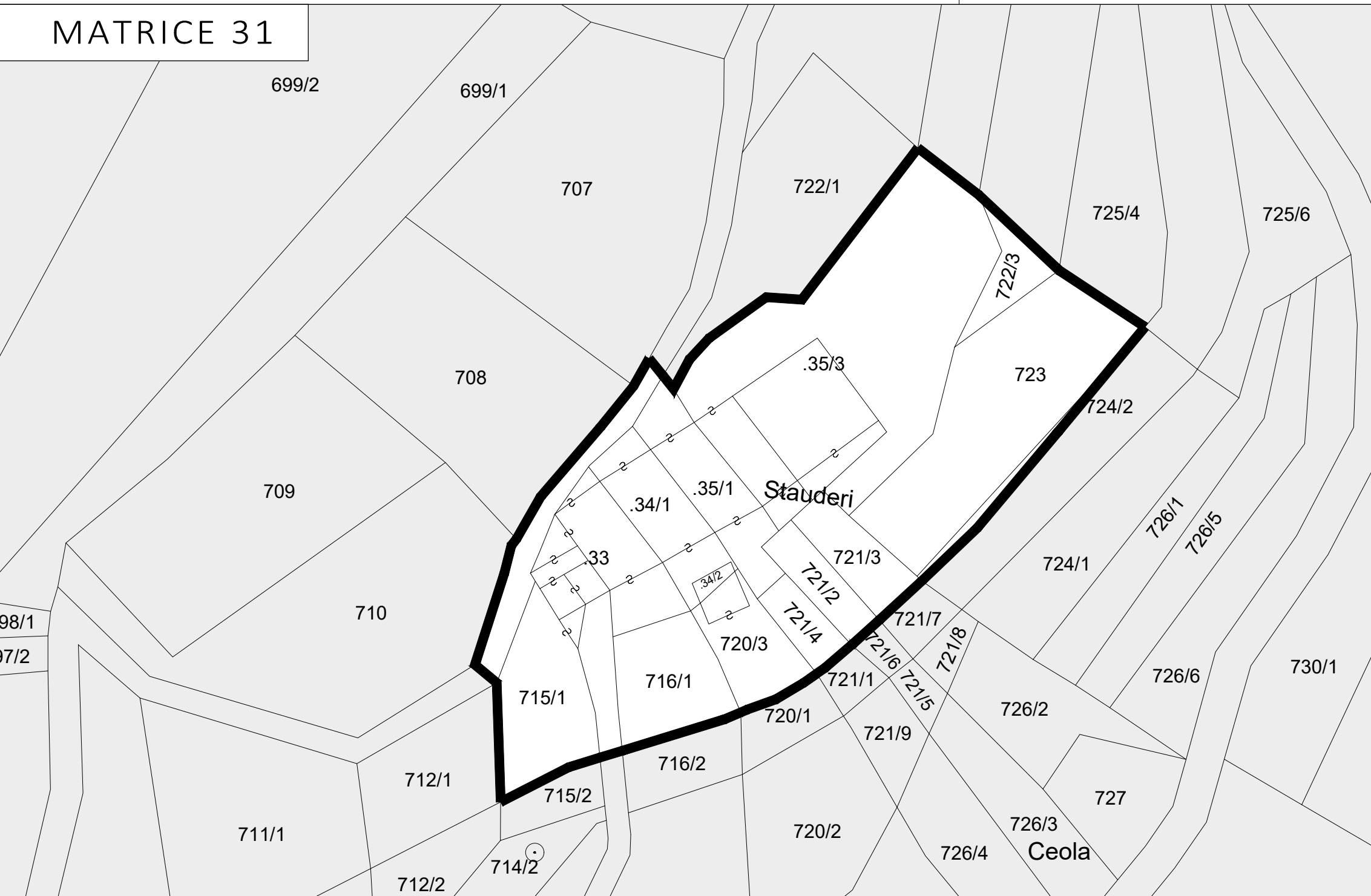

MATRICE 32

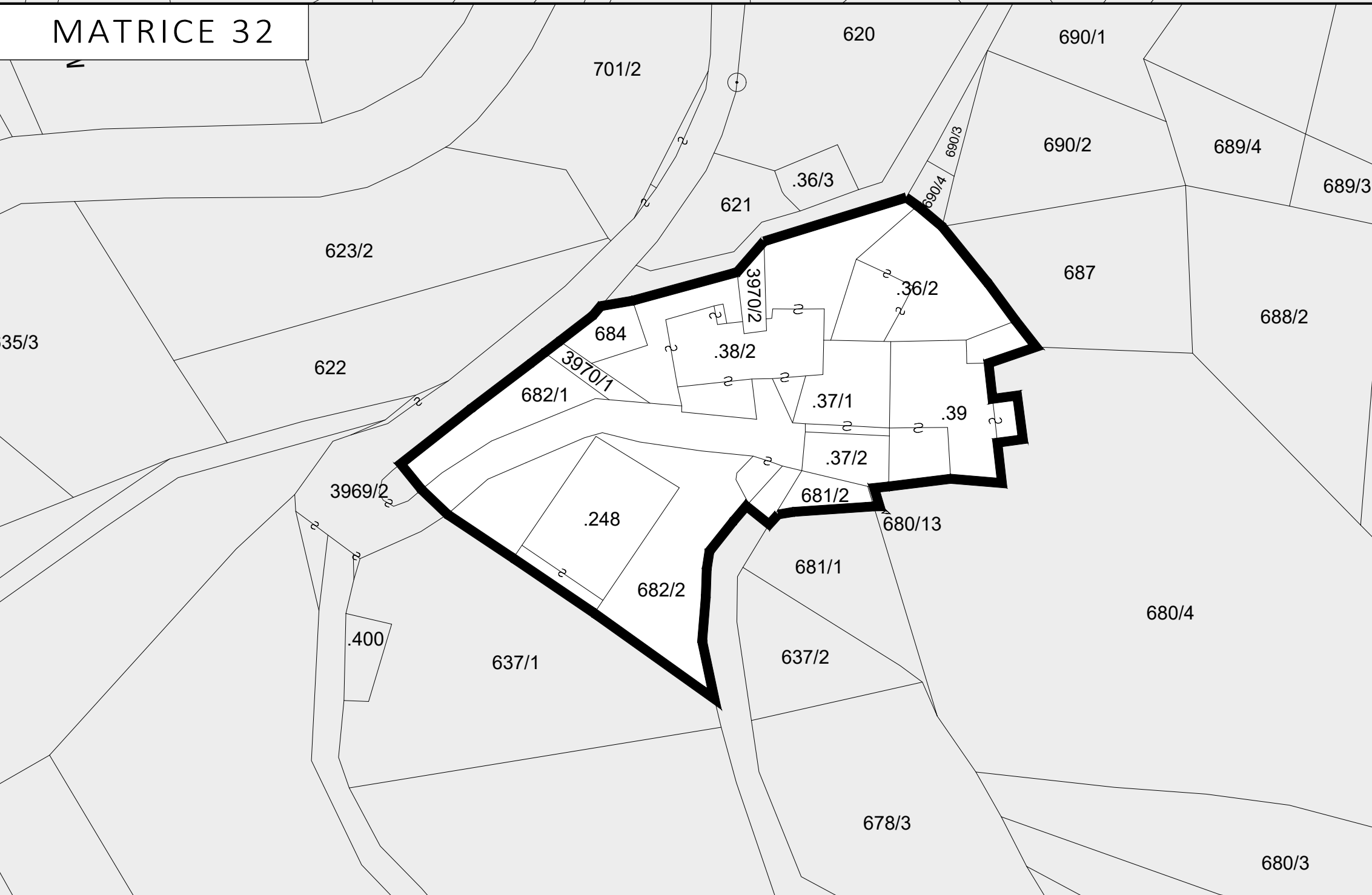

MATRICE 34

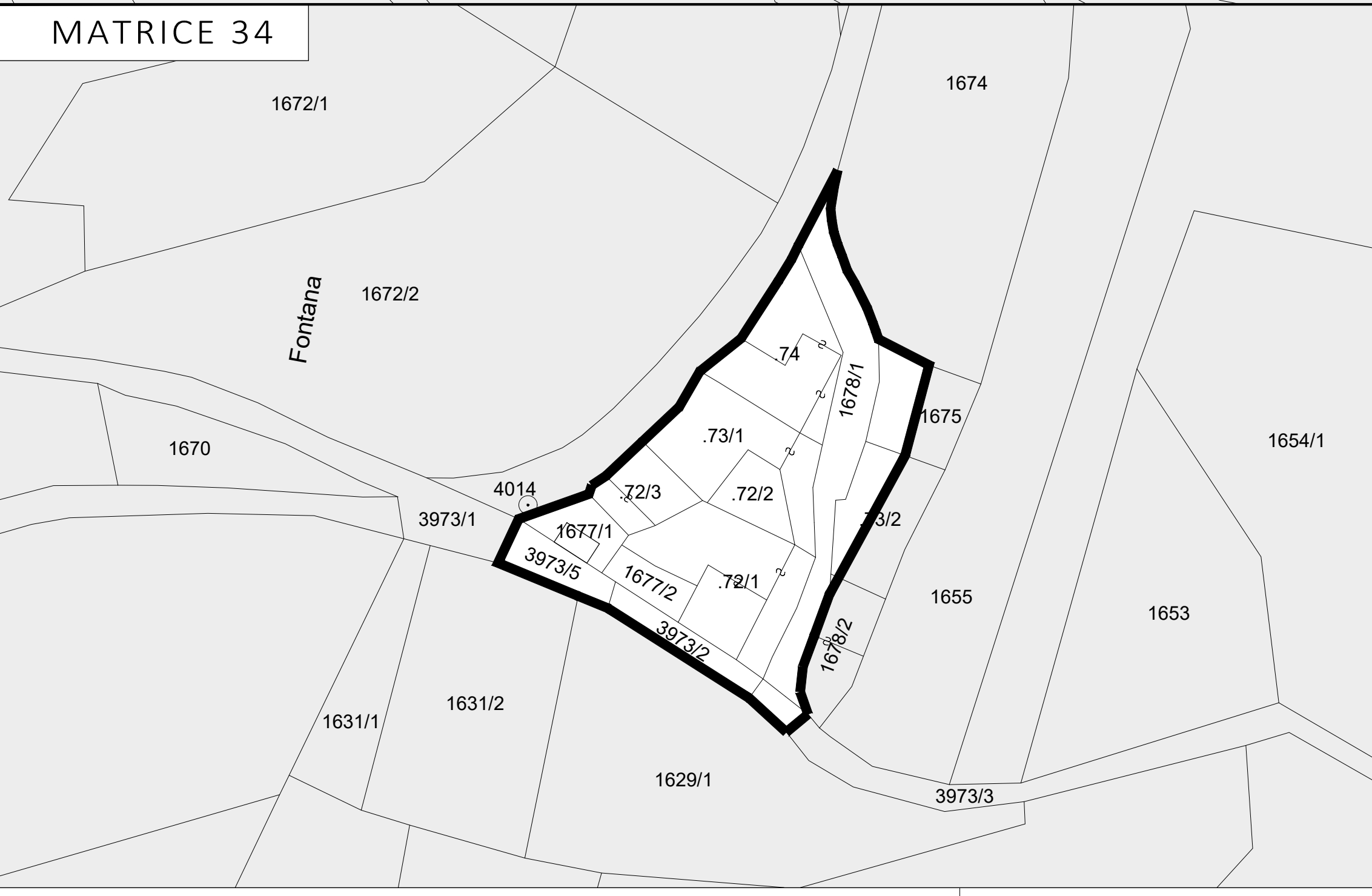

MATRICE 35

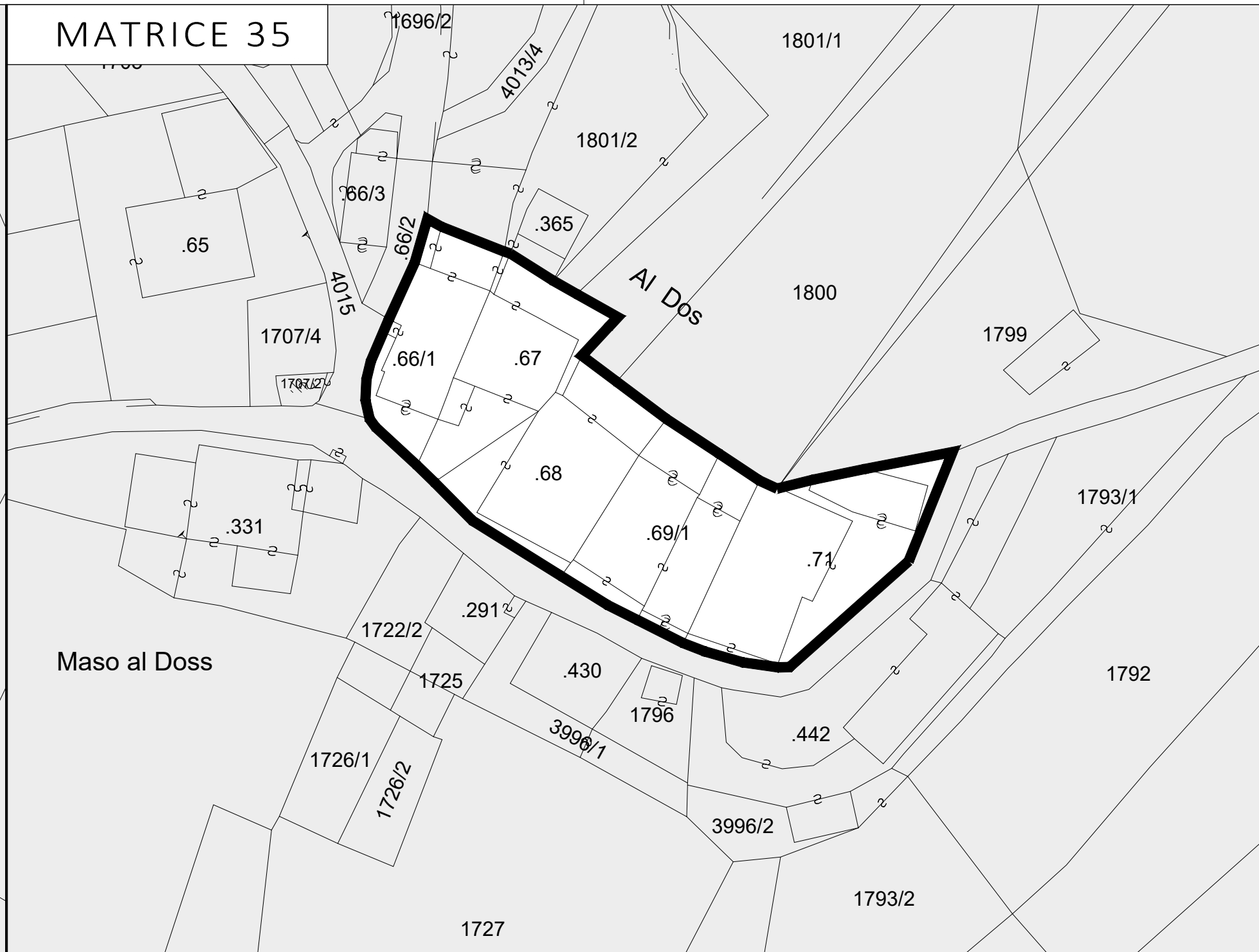

MATRICE 36

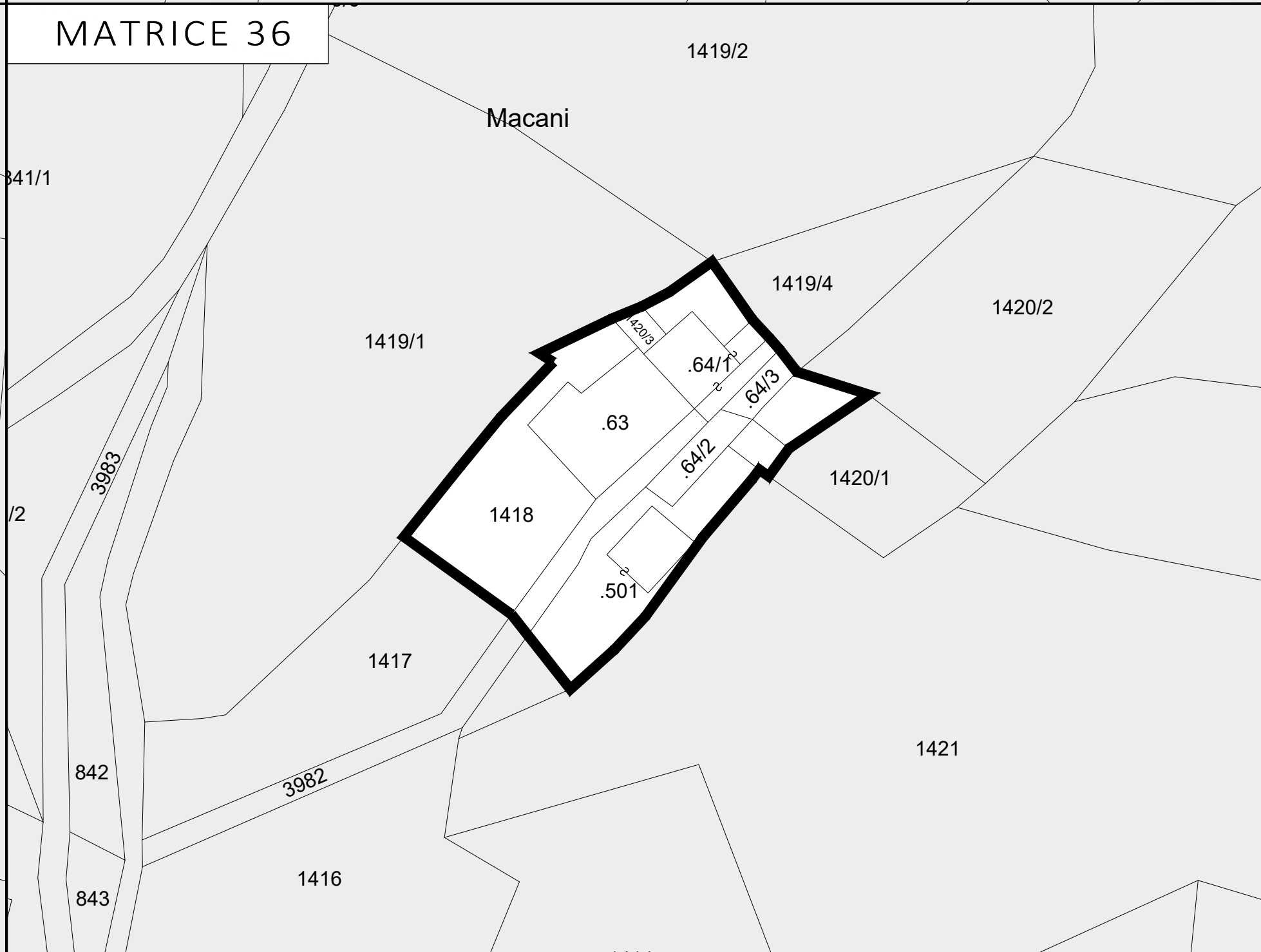

MATRICE 38

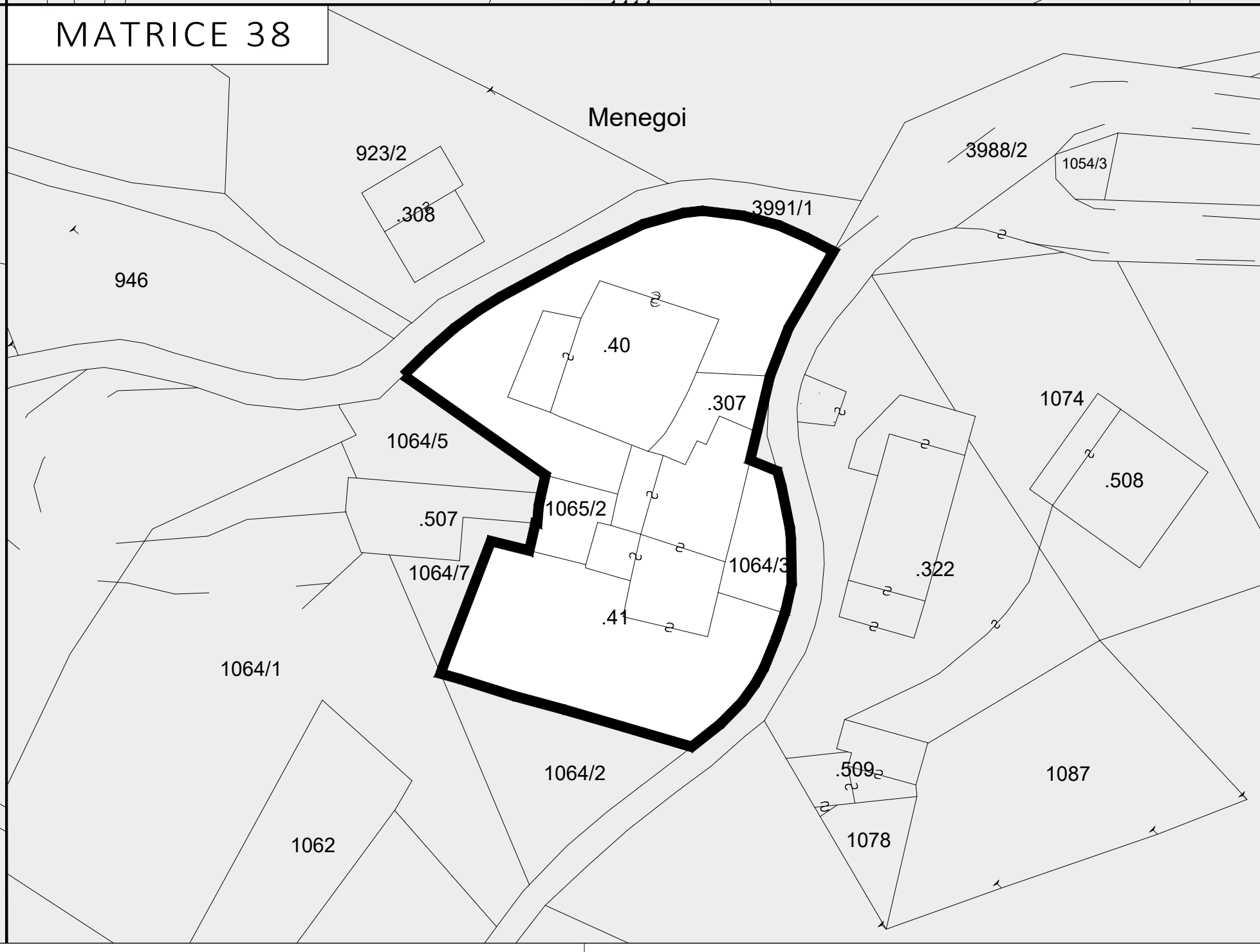

MATRICE 37

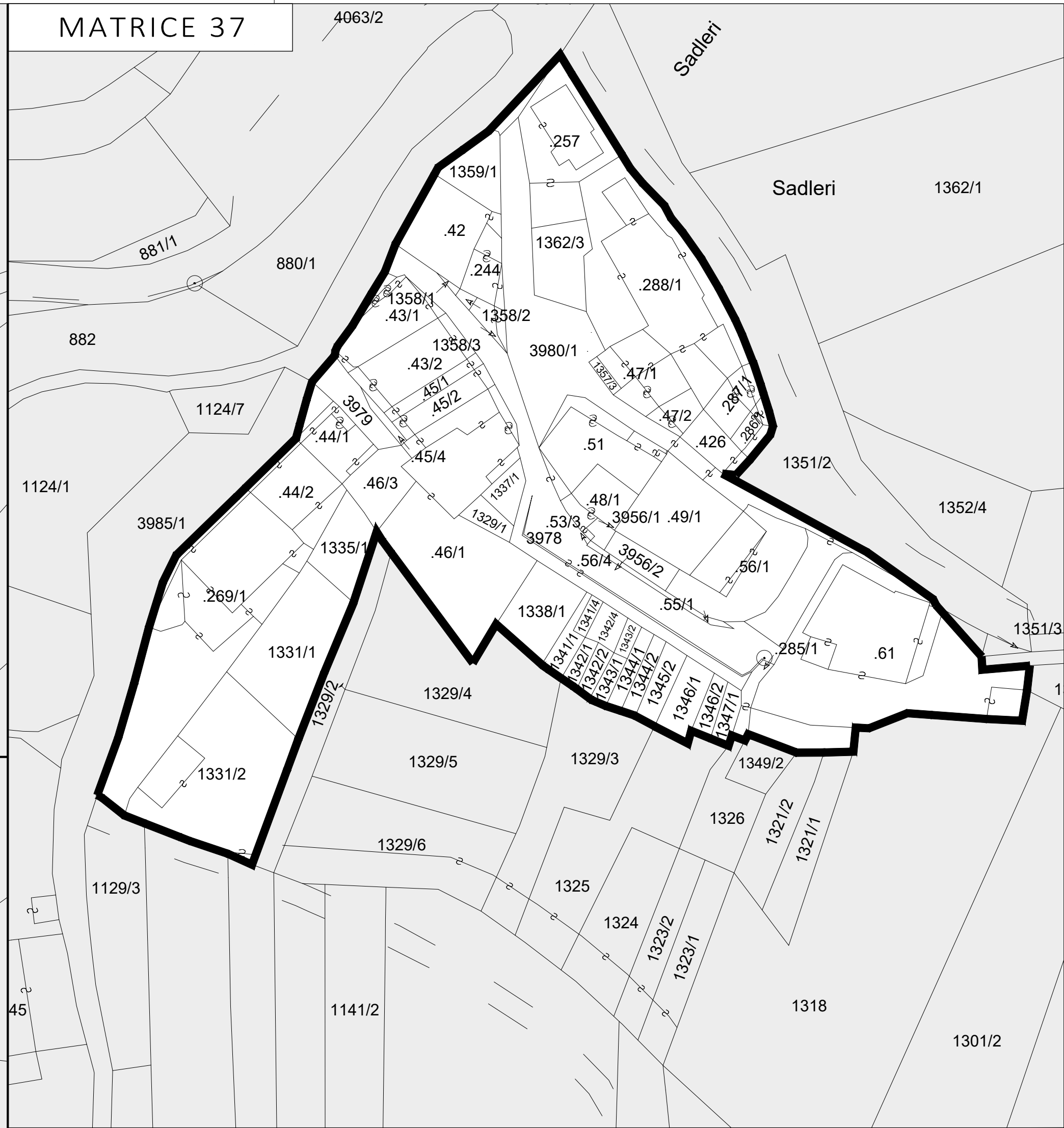

MATRICE 33

